

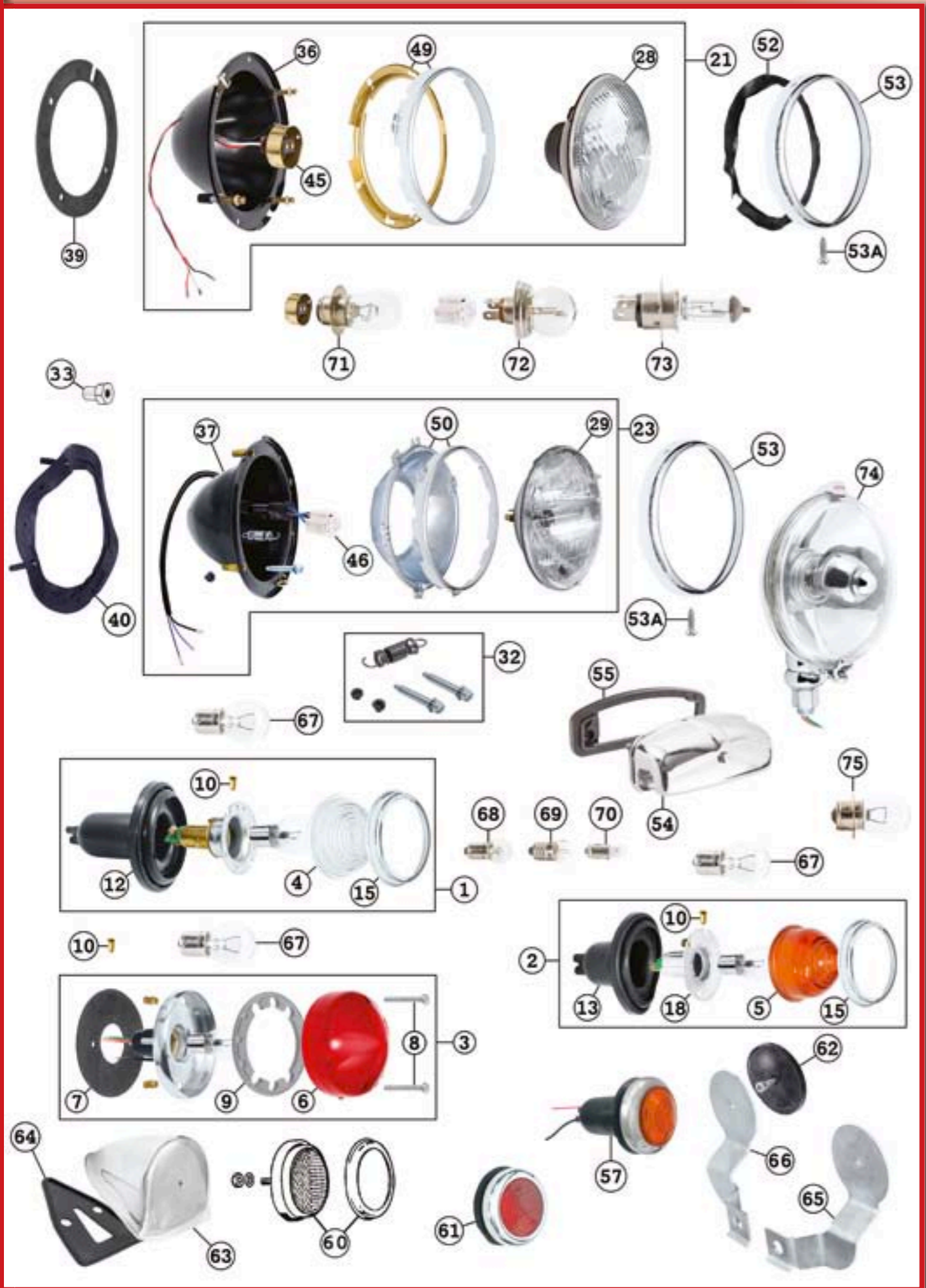

No.	Part No.	Description	Application	Notes	Price ex VAT
1	LTG101	SIDE/FLASHER LIGHT-FRONT(assy)	BN1-BN2		£14.95
1	LTG101A	SIDE/FLASHER LIGHT-FRONT(AMBER)	BN1-BN2	NON ORIGINAL	£14.95
1	LTG101S	SIDE LIGHT-FRONT(assy)	100S		£59.95
2	LTG102	SIDE/FLASHER LIGHT-FRONT(assy)	BN4-BJ8.26704		£13.95
3	LTG103	SIDE/FLASHER LIGHT-FRONT(assy)	BJ8.26705-(B)76137		£16.30
3	LTG104	SIDE/LIGHT-FRONT(assy)	BJ8(B)76138 ON		£16.30
1	LTG110	TAIL/FLASHER LIGHT(assy)	BN1-BN2		£14.95
2	LTG111	TAIL/FLASHER LIGHT(assy)	BN4-BJ8.26704		£13.95
3	LTG112	TAIL/FLASHER LIGHT(assy)	BJ8.26705-(B)76137		£16.30
3	LTG113	TAIL LIGHT(assy) USE LTG112	BJ8(B)76138 ON	USE.LTG112	-
3	LTG116	FLASHER LIGHT-front&rear	BJ8(B)76138 ON		£16.30
4	LTG120	LENS-clear	BN1-BN2		£5.75
5	LTG121	LENS-clear	BN4-BJ8.26704		£4.75
6	LTG122	LENS-clear	BJ8.26705 ON		£4.95
4	LTG130	LENS-red	BN1-BN2		£5.95
5	LTG131	LENS-red	BN4-BJ8.26704		£5.95
6	LTG132	LENS-red	BJ8.26705 ON		£5.00
5	LTG140	LENS-amber	BN4-BJ7	A/R	£6.40
6	LTG141	LENS-amber	BJ8(B)76138 ON		£5.95
7	LTG143	GASKET-lamp to body	BJ8.26705 ON		£1.10
8	LTG145	SCREW-lens retaining	BJ8.26705 ON		£0.99
9	LTG146	GASKET-lens seating	BJ8.26705 ON		£0.89
10	LTG147	SLEEVE-connecting	BN1-BJ8		£0.25
12	LTG150	LIGHT BODY(rubber)	BN1-BN2		£2.60
13	LTG151	LIGHT BODY(rubber)	BN4-BJ8.26704		£2.40
15	LTG154	RIM,CHROME-light body	BN1-BJ8.26704		£1.95
18	LTG157	BULB HOLDER	BN4-BJ8.26704		£4.95
18	LTG158	BULB HOLDER-SINGLE FILAMENT	A/R		£4.95
21	LTG160	HEAD LAMP(bulb type)-RHD	BN1-BJ8		£43.75
21	LTG161	HEAD LAMP(bulb type)-LHD	BN1-BJ8		£43.75
23	LTG163	HEAD LAMP(sealed beam)-RHD	BJ8		£51.50
23	LTG164	HEAD LAMP(sealed beam)-LHD	BJ8		£42.50
23	LTG165	HEAD LAMP(quartz hal.)-LHD	A/R	LUCAS H4	£62.95
28	LTG166	QUARTZ HALOGEN CONVERSION KIT LUCAS H4	A/R	RHD PR	£69.95
28	LTG166A	QUARTZ HALOGEN CONVERSION KIT LUCAS H4	A/R	RHD WITH PILOT PR	£69.95
28	LTG167	QUARTZ HALOGEN CONVERSION KIT LUCAS H4	A/R	LHD PR	£69.95
28	LTG167A	QUARTZ HALOGEN CONVERSION KIT LUCAS H4	A/R	LHD WITH PILOT PR	£69.95
28	LTG168	LIGHT UNIT(PL bulb type)-RHD	BN1-BJ8	PL TYPE	£58.75
28	LTG169	LIGHT UNIT(PL bulb type)-LHD	BN1-BJ8	PL TYPE	£58.75
28	LTG169LM	LE MANS LUCAS LIGHT UNIT	100M&100S	PF700 BPF BULB FITTING	£134.95
28	LTG170	LIGHT UNIT(bulb type)-RHD-LUCAS	BN1-BJ8	USES LTG229	£27.50
28	LTG170P	LIGHT UNIT(bulb type)-RHD-LUCAS	BN1-BJ8	USES LTG229 WITH PILOT	£27.50
28	LTG171	LIGHT UNIT(bulb type)-LHD-LUCAS	BN1-BJ8	USES LTG229A	£32.50
28	LTG171P	LIGHT UNIT(bulb type)-LHD-LUCAS	BN1-BJ8	USES LTG229A WITH PILOT	£32.50
29	LTG172	LIGHT UNIT (sealed beam)-RHD	BJ8	LUCAS	£19.95
29	LTG173	LIGHT UNIT(sealed beam)-LHD	BJ8		£19.95
32	LTG175	ADJUSTING SCREW SET	A/R	BULB TYPE	£4.35
32	LTG176	ADJUSTING SCREW SET	A/R	SEALED BEAM	£4.75
33	LTG177	BRASS NUT-H/L bucket to body	BN1-BJ8		£2.30

LIGHTING



No.	Part No.	Description	Application	Notes	Price ex VAT
36	LTG181	BOWL-headlamp	A/R	BULB TYPE	£13.95
37	LTG182	BOWL-headlamp-with adjusters	A/R	SEALED BEAM	£9.85
39	LTG184	GASKET-bowl to body(3adj.type)	BN1-BJ8		£3.65
40	LTG185	GASKET-bowl to body(2adj.type)	BJ8		£2.35
45	LTG190	PIGTAIL-headlamp(c/w/adaptor)	BN1-BJ8		£9.50
46	LTG191	PIGTAIL-headlamp(c/w adaptor)	BJ8	SEALED BEAM	£8.75
49	LTG194	INNER RIM ASSY.(3adj.type)	BN1-BJ8		£12.95
50	LTG195	INNER RIM ASSY.(2adj.type)	BJ8		£13.50
52	LTG197	DUST EXCLUDER-rubber	BN4-BT7		£2.85
53	LTG198	HEADLAMP RIM-chrome	BN1-BN2		£13.50
53	LTG198P	HEADLAMP RIM-chrome	BN1-BN2	PREMIUM	£29.95
53	LTG199	HEADLAMP RIM-chrome	BN4-BJ8		£27.95
53	LTG199P	HEADLAMP RIM-chrome	BN4-BJ8	PREMIUM	£33.95
53A	LTG200	SCREW - rim retaining	BN1-BJ8		£0.55
54	LTG201	NUMBER PLATE LIGHT	BN1-BJ8		£19.95
55	LTG202	RUBBER PAD-number plate lamp	BN1-BJ8		£2.75
57	LTG207	INDICATOR LAMP-fits in shroud	BN4-BJ7	NON STANDARD	£48.50
60	LTG210	REFLECTOR	BN1-BN2		£11.50
		 <p>LTG207</p> <p>Cleverly designed to fit in the reflector pod of the rear shroud.</p> <p>This lamp enables you to have separate brake and indicator lamps as used on the later BJ8's.</p> <p>You do still need to fit reflectors by law in most countries and if required; they can be mounted on the bumper by using LTG218, LTG219 and LTG212.</p>			
61	LTG211	REFLECTOR	BN4-BJ8(B)76137		£21.50
62	LTG212	REFLECTOR	BJ8(B)76138 ON		£8.95
63	LTG213	PODS-reflector mtg.,RH	BN1-BN2		£29.50
63	LTG214	PODS-reflector mtg.,LH	BN1-BN2		£29.50
64	LTG215	RUBBER PAD-pod to body,RH	BN1-BN2		£4.65
64	LTG216	RUBBER PAD-pod to body,LH	BN1-BN2		£4.65
65	LTG218	MOUNTING BRACKET-reflector,R/H	BJ8(B)76138 ON		£10.35
66	LTG219	MOUNTING BRACKET-reflector,L/H	BJ8(B)76138 ON		£10.35
67	LTG220	BULB-side/stop/tail	BN1-BJ8		£0.56
67	LTG221	BULB-sidelight	BJ8		£0.40
67	LTG222	BULB-flasher	BJ8(B)76138 ON		£0.42
68	LTG223	BULB-number plate light	BN1-BJ8		£0.47
69	LTG223A	BULB-instrument lighting-modern	BN1-BJ8	FOR REPRO HARNESS	£0.55
69	LTG224	BULB-instrument lighting	BN1-BJ8	SCREW FITTING	£0.55
70	LTG224A	BULB-warning lamp-bayonet type	BN1-BJ8		£0.42
71	LTG225	BULB-headlamp,bayonet fitting	BN1-BJ8	(TYPE.414)	£3.95
72	LTG226	BULB-headlamp,spade fitting	BN1-BJ8	(TYPE.410)	£1.85
73	LTG228	BULB-headlamp,quartz halogen	BN1-BJ8	REPLACES T.414	£11.95
73	LTG229	BULB-headlamp,quartz halogen H4-LUCAS	BN1-BJ8	H4 3-PRONG FITTING	£3.50
73	LTG229A	BULB-headlamp,quartz halogen H4-LUCAS	BN1-BJ8	H4 ROUND BASE FITTING	£3.95
74	LTG230	FOG LAMP-SFT576	A/R	REPRO	£69.00
74	LTG231	SPOT LAMP-SLR576	A/R	REPRO	£69.00
74	LTG233	SPOT LAMP-SLR700	A/R		£109.00
74	LTG234	FOG LAMP-SFT700	A/R		£109.00
75	LTG235	BULB-fog & spot lamps	A/R		£4.70