

COMPETITION PARTS - 1

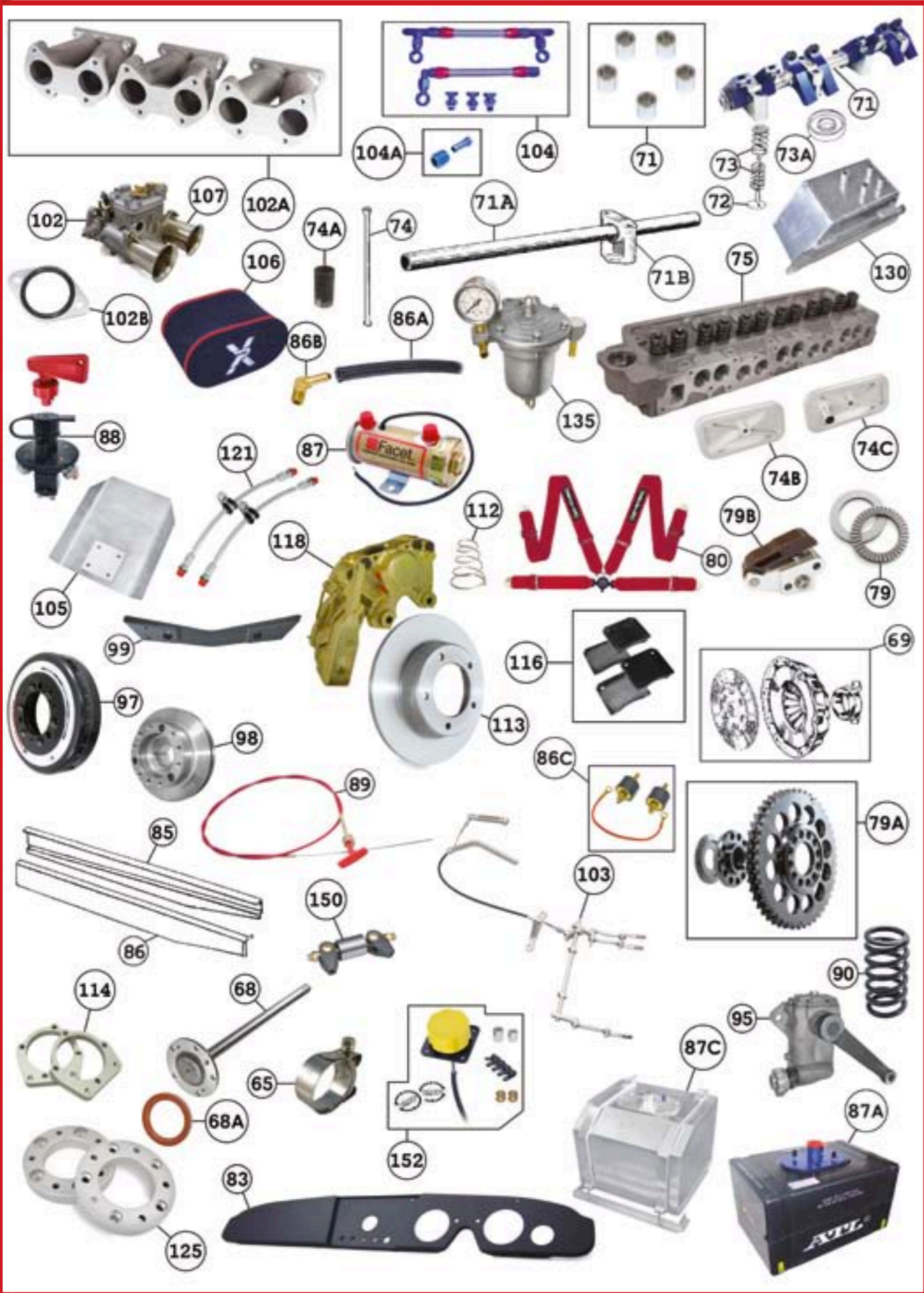

| No. | Part No. | Description | Application | Notes | Price ex VAT |
|-----|----------|---------------------------------|-------------|----------------------------------|--------------|
| 1 | COM101 | FRONT WING-aluminium,RH | BN4-BJ8 | WITH VENTS | £710.00 |
| 1 | COM102 | FRONT WING-aluminium,LH | BN4-BJ8 | WITH VENTS | £710.00 |
| 2 | COM105 | FRONT WING-aluminium,RH | BN4-BJ8 | FLARED ARCHES | £695.00 |
| 2 | COM106 | FRONT WING-aluminium,LH | BN4-BJ8 | FLARED ARCHES | £695.00 |
| 3 | COM110 | FRONT WING-aluminium,R/H | BN4-BJ8 | VENTS & FLARED | £736.50 |
| 3 | COM111 | FRONT WING-aluminium,L/H | BN4-BJ8 | VENTS & FLARED | £736.50 |
| 4 | COM113 | VENTS-aluminium-front wings-pr | BN1-BJ8 | OUTER FLANGE | £149.50 |
| 4 | COM113S | VENTS-steel-front wings-pr | BN1-BJ8 | OUTER FLANGE | £149.50 |
| 4 | COM114 | VENTS-aluminium-front wings-pr | BN1-BJ8 | NO FLANGE | £105.00 |
| 4 | COM114S | VENTS-steel-front wings-pr | BN1-BJ8 | NO FLANGE | £105.00 |
| 5 | COM115 | REAR WING-aluminium,RH | BN2-BJ8 | SMALL FLARES | £559.00 |
| 5 | COM116 | REAR WING-aluminium,LH | BN2-BJ8 | SMALL FLARES | £559.00 |
| 6 | COM120 | REAR WING-aluminium,RH | BN2-BJ8 | LARGE FLARES | £589.00 |
| 6 | COM121 | REAR WING-aluminium,LH | BN2-BJ8 | LARGE FLARES | £589.00 |
| 7 | COM130 | BONNET LOUVERED-aluminium | BN1-BN2 | USE.OBP243 | - |
| 8 | COM135 | BONNET LOUVERED-aluminium | BN4-BJ8 | USE.OBP255 | - |
| 9 | COM140 | BOOT LID-aluminium-works type | BN4-BJ8 | | £995.00 |
| 10 | COM150 | ANTI-ROLL BAR 3/4'(up rated) | A/R | USE.SUF192 | - |
| 10 | COM151 | ANTI-ROLL BAR KIT 7/8'-competrn | A/R | USE.SUF192K | - |
| 10A | COM154 | REAR ANTI ROLL BAR KIT | BN1-BJ8 | INC FITTING KIT | £184.95 |
| 11 | COM160 | GEAR LEVER KNOB-works type | BN4-BJ8 | WITH O/D SWITCH | £37.50 |
| 12 | COM161 | CONVERSION KIT-rear crank seal | BN1-BN2 | USE.ENG430 | - |
| 12 | COM162 | CONVERSION KIT-rear crank seal | BN4-BJ8 | | £42.95 |
| 13 | COM163 | OIL SEAL-rear crank | BN1-BJ8 | | £8.50 |
| 15 | COM164 | BRAKE PADS-COMPETITION-kevlar | TYPE 14 | ROAD/FAST ROAD | £78.00 |
| 15 | COM166 | BRAKE PADS-COMPETITION-kevlar | TYPE 16 | ROAD/FAST ROAD | £43.50 |
| 15 | COM167 | BRAKE PADS-COMPETITION-kevlar | TYPE 16 | FAST ROAD/RACE | £43.95 |
| 15 | COM167R | BRAKE PADS-COMPETITION-kevlar | TYPE 16 | FULL RACE | £54.50 |
| 16 | COM168 | TURBO BRAKE DISCS-TYPE 14-pair | | USE WITH KEVLAR PADS | £196.50 |
| 16 | COM169 | TURBO BRAKE DISCS-TYPE 16-pair | | USE WITH KEVLAR PADS | £189.50 |
| 16 | COM169R | COMPETITON THICK BRAKE DISCS | BN1-BJ7 | NOT BJ8 STUB AXELS | £139.50 |
| 17 | COM170 | SWITCH & HARNESS-gear knob | BN4-BJ8 | | £12.50 |
| 19 | COM171 | SPARK PLUG-NGK-high performance | BN1-BN2 | | £2.95 |
| 19 | COM172 | SPARK PLUG-NGK-high performance | BN4-BJ8 | | £2.85 |
| 19 | COM172R | SPARK PLUG-NGK-high performance | BN4-BJ8 | RACE/RALLY | £3.95 |
| 19 | COM173 | SPARK PLUG-NGK-IRIDIUM | BN4-BJ8 | FAST ROAD/RACE | £12.95 |
| 19 | COM173A | SPARK PLUG-NGK-IRIDIUM | BN4-BJ8 | RACE/RALLY | £12.95 |
| 21 | COM174 | ALUMINIUM RALLY FUEL TANK | BN4-BJ8 | 80 LITRE | £385.00 |
| 22 | COM176 | SUMP GUARD - aluminium | A/R | | £149.50 |
| 24 | COM178 | MOUNTING PLATES-ADJUSTABLE-PR | BN1-BJ8 | FRONT S/ABSORBER | £94.50 |
| 25 | COM179 | ALTERNATOR BELT | BN4-BJ8 | | £4.45 |
| 25 | COM179NA | ALTERNATOR BELT-narrow type | BN1-BN2 | NARROW BELT TYPE | £8.35 |
| 26 | COM180 | ALTERNATOR KIT-45amp-complete | BN4-BJ8 | RECOMMEND USING ELG267 OR ELG268 | £138.50 |
| 26A | COM180A | ALTERNATOR-45amp | BN1-BJ8 | INC PULLEY+FAN | £73.50 |
| 26B | COM180B | ALTERNATOR MOUNTING BRACKET | BN4-BJ8 | | £62.95 |
| 26B | COM180C | ALTERNATOR MOUNTING BRACKET | BN1-BN2 | | £47.50 |
| 26C | COM180D | ALTERNATOR PULLEY-Wide | BN1-BN2 | Aluminium | £24.50 |
| 27 | COM181 | ADJUSTING STRAP - ALTERNATOR | BN4-BJ8 | REQ'D FOR RHD CARS | £10.95 |

COMPETITION PARTS - 1

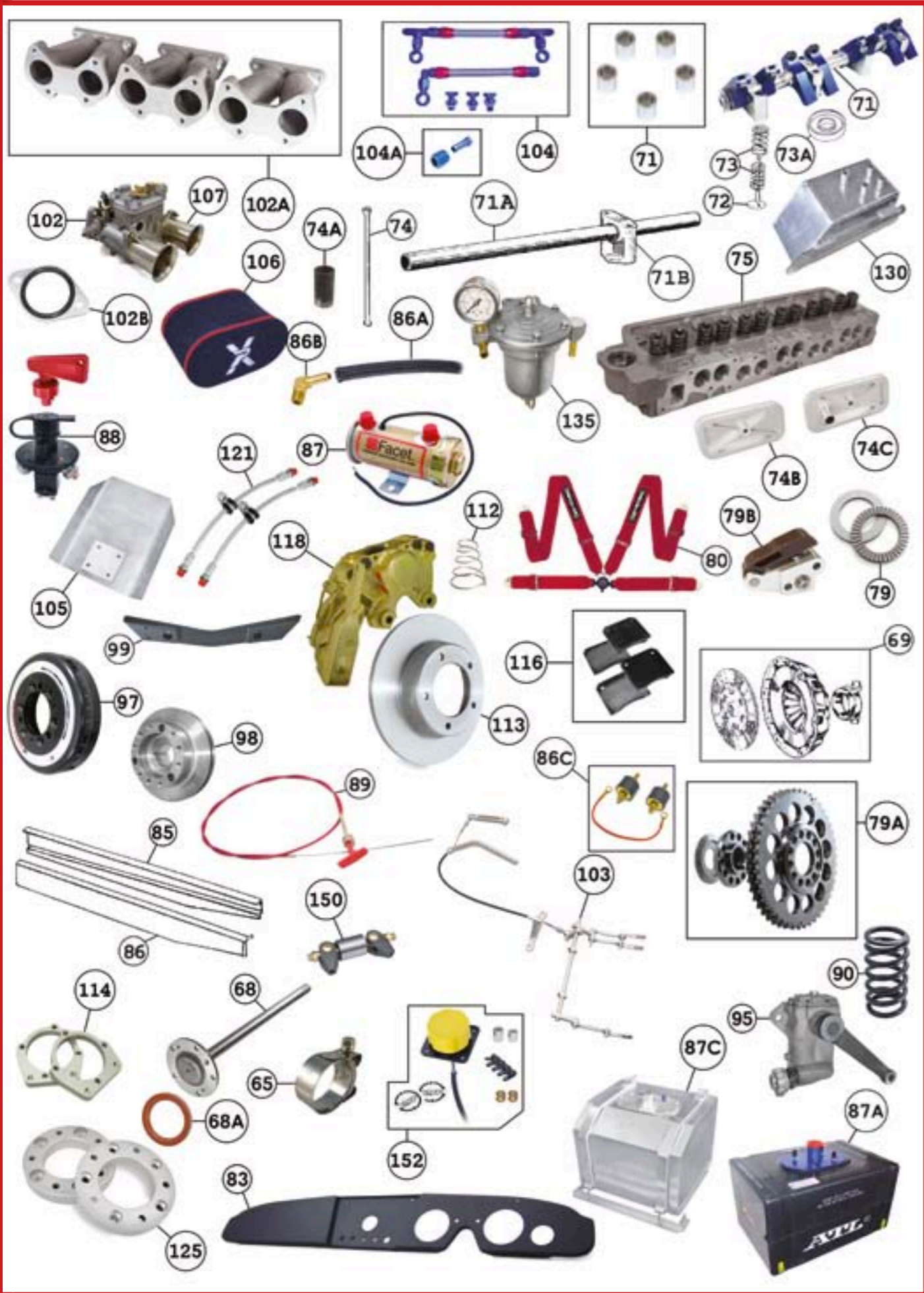

| No. | Part No. | Description | Application | Notes | Price ex VAT |
|-----|-----------|--|---------------------|------------------------|--------------|
| 28 | COM183 | GEAR REDUCTION STARTER MOTOR | BN1-BJ8 | STD RING GEAR | £159.95 |
| 28 | COM183R | GEAR REDUCTION STARTER MOTOR | BN1-BJ8 | THIN RING GEAR ONLY | £183.50 |
| 29 | COM184 | CALIPERS-COMPETITION-PR | TYPE 14 | USES BJ8 PADS | £212.50 |
| 29 | COM185 | FRONT DISC BRAKE CONVERSION KIT | BN1 | | £849.00 |
| 29 | COM185+4P | ALI 4 POT FRONT DISC BRAKE CONVERSION KIT | BN1 | 4 POT ALI CALIPERS | £1,350.00 |
| 29 | COM186 | FRONT DISC BRAKE CONVERSION KIT | BN2-BN6 | WIRE WHEELS ONLY | £835.00 |
| 29 | COM186+4P | ALI 4 POT FRONT DISC BRAKE CONVERSION KIT | BN2-BN6 | 4 POT ALI CALIPERS | £1,285.00 |
| 29 | COM187 | FRONT EBC DISC BRAKE CONVERSION KIT | BN2-BN6 | WIRE WHEELS ONLY | £835.00 |
| 30 | COM188 | COMP BRAKE SERVO | A/R | HIGH KNEE POINT | £199.95 |
| 32 | COM189 | MASTER CYLINDER - dual brakes | BN4-BJ8 | | £218.00 |
| 33 | COM190 | LIMITED SLIP DIFF. - QUAIFE | BN1.221536-BJ8 | | £869.50 |
| 33 | COM191 | LIMITED SLIP DIFF.45/45 - clutch type | BN2-BJ8 | FAST ROAD/RALLY | £895.00 |
| 33 | COM192 | LIMITED SLIP DIFF.30/60 - clutch type | BN2-BJ8 | RACE | £895.00 |
| 33 | COM193 | LIMITED SLIP DIFF.30/90 or 45/90 - clutch type | BN2-BJ8 | FULL RACE | £895.00 |
| 34 | COM194 | CROWN WHEEL & PINION 4.3:1 | BN1.221536-BJ8 | | £395.00 |
| 34A | COM194A | OIL STRAINER | BN1-BN2 | ALUMINIUM SUMP ONLY | £41.75 |
| 34B | COM194B | ALUMINIUM OIL SUMP BAFFLE | BN1-BN2 | ALUMINIUM SUMP | £19.95 |
| 35 | COM194F | ALUMINIUM OIL SUMP | BN1-BN2 | | £165.00 |
| 35 | COM195 | ALUMINIUM OIL SUMP | BN4-BJ8 | | £185.00 |
| 37 | COM197 | TOP TRUNNION BEARING KIT-PAIR | BN1-BJ8 | USE.SUF125 | - |
| 38 | COM198 | SHIM-0.004'-trunnion bearing | BN1-BJ8 | USE.SUF126 | - |
| 40 | COM199 | COMPETITION IGNITION LEAD SET | BN1-BN2 | NGK CAPS | £25.50 |
| 40 | COM200 | COMPETITION IGNITION LEAD SET | BN4-BJ8 | NGK CAPS | £33.50 |
| 41 | COM201 | COMPETITION H.T.LEAD(per metre) | BN1-BJ8 | | £3.50 |
| 42 | COM202S | SPAX TELESCOPIC FRONT SUSPENSION KIT | BN1-BJ8 | SPAX ADJUSTABLE SHOCKS | £375.00 |
| 42 | COM203 | SPAX ADJUSTABLE FRONT DAMPER | BN1-BJ8 | | £85.00 |
| 44 | COM204S | SPAX TELESCOPIC REAR SUSPENSION KIT | BN1-BJ8 26704 | SPAX ADJUSTABLE SHOCKS | £385.00 |
| 44 | COM205 | TELESCOPIC REAR SUSPENSION KIT | BJ8 26705-ON | | £398.00 |
| 44 | COM205S | SPAX TELESCOPIC REAR SUSPENSION KIT | BJ8 26705-ON | SPAX ADJUSTABLE SHOCKS | £392.50 |
| 44 | COM206 | SPAX ADJUSTABLE REAR DAMPER | BN1-BJ8 26704 | | £82.50 |
| 44 | COM207 | SPAX ADJUSTABLE REAR DAMPER | BJ8 26705-ON | | £93.00 |
| 46 | COM208 | COMPETITION REAR SPRING | BN1-BJ8 | RACE SPEC | £125.50 |
| 46 | COM208UR | REAR SPRING - ULTIMATE RACE SPEC. | BN1-BJ8 | RACE SPEC | £285.00 |
| 47 | COM209 | TRAMP BAR KIT | BN2-BJ7 | | £122.50 |
| 47A | COM211 | REAR LOWERING KIT | BN1-BJ8 | LOWERS BY APPROX 1" | £31.00 |
| 47B | COM212 | FRONT LOWERING KIT | BN1-BJ8 | MUST USE WITH COM213 | £17.50 |
| 47C | COM213 | BUMP STOP KIT | BN1-BJ8 | | £36.00 |
| 48 | COM215 | HEAT RESISTANT CLOTH(1m)-per metre | A/R | USE.CAB180 | - |
| 50 | COM217 | PROPSHAFT - high deflection | BN1-BJ8 | RALLY/RACE | £169.50 |
| 54 | COM220 | STRAIGHT CUT GEAR SET-sebring | ENQUIRE FOR DETAILS | | £825.00 |
| 54 | COM221 | STRAIGHT CUT GEAR SET-tulip | ENQUIRE FOR DETAILS | | £825.00 |
| 56 | COM224 | FORGED PISTONS - 88mm(3.4646") | BN1-BN2 | HIGH PERFORMANCE | £485.00 |
| 56 | COM226 | FORGED PISTONS - 84.5mm(3.3268") | BN4-BJ8 | HIGH PERFORMANCE | £815.00 |
| 56 | COM226R | RING SET FORGED PISTON-84.5mm(3.3268") | BN4-BJ8 | PER PISTON | £27.95 |
| 56 | COM227 | FORGED PISTONS - 85mm(3.34645") | BN4-BJ8 | HIGH PERFORMANCE | £815.00 |
| 56 | COM227R | RING SET FORGED PISTON-85mm(3.34645") | BN4-BJ8 | PER PISTON | £27.95 |
| 59 | COM230 | STEEL CON ROD SET-H section-forged | BN1-BN2 | MUST USE STEEL CRANK | £1,050.00 |
| 59 | COM234 | STEEL CON ROD SET-H section-forged | BN4-BJ8 | MUST USE STEEL CRANK | £1,150.00 |

COMPETITION PARTS - 1

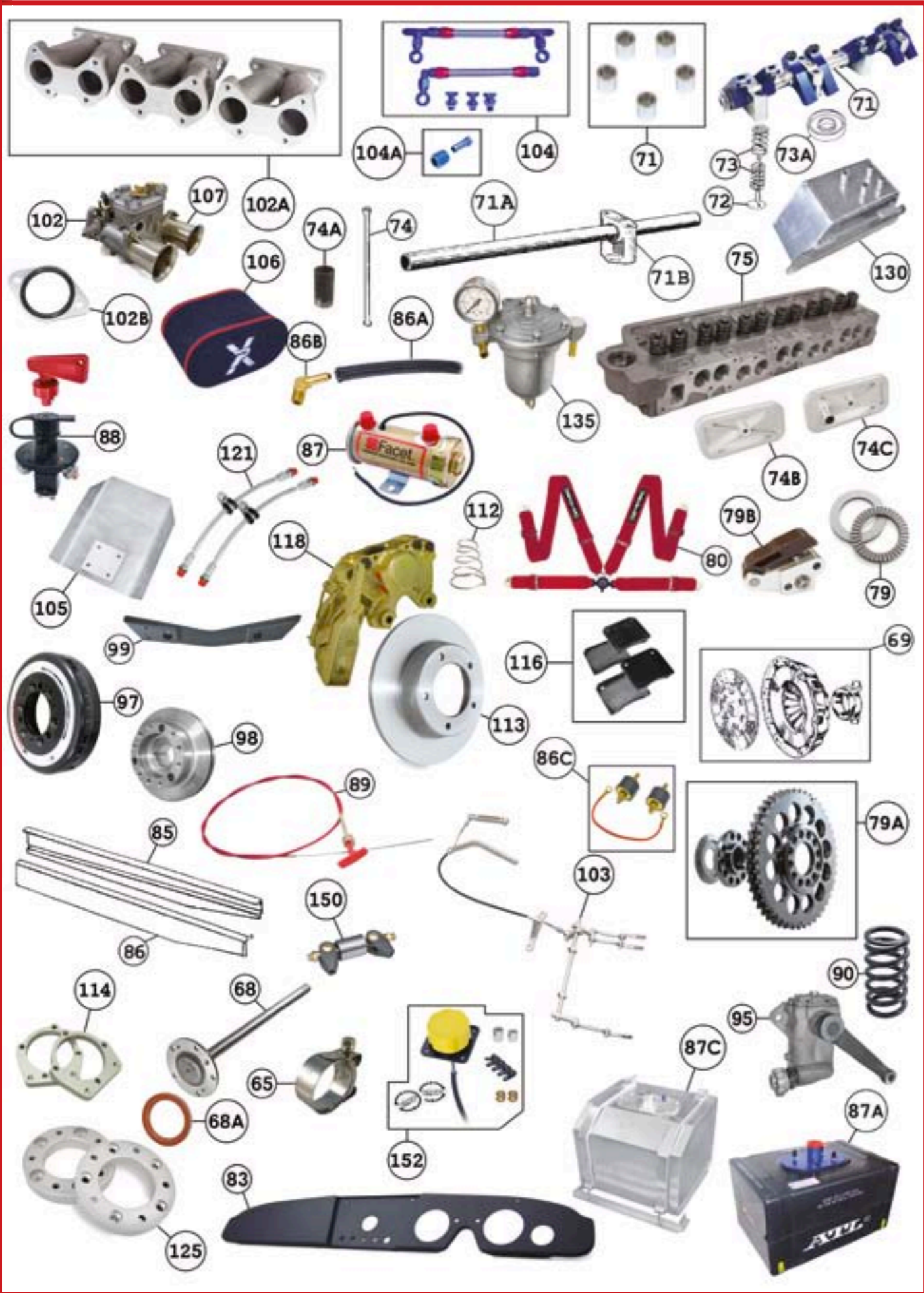

| No. | Part No. | Description | Application | Notes | Price ex VAT |
|-----|----------|------------------------------------|-------------|-----------------------------|--------------|
| 60 | COM235 | STEEL FLYWHEEL 9.5" - 8 BOLT | BN1-BJ8 | ALSO FITS STD CRANK | £289.00 |
| 60 | COM236 | STEEL FLYWHEEL 9.5" - 12 BOLT | BN1-BJ8 | | £289.00 |
| 60 | COM236A | STEEL FLYWHEEL 7.25" - 8 BOLT | BN1-BJ8 | 7.1/4" RACE CLUTCH | £365.00 |
| 60 | COM236B | STEEL FLYWHEEL 7.25" - 12 BOLT | BN1-BJ8 | 7.1/4" RACE CLUTCH | £365.00 |
| 60 | COM236R | LIGHTWEIGHT STARTER RING GEAR | BN1-BJ8 | USE.ENG635R | - |
| 61 | COM237 | STEEL CRANKSHAFT - 8 BOLT | BN1-BN2 | FOR 8 BOLT FLYWHEEL | £2,065.00 |
| 61 | COM238 | STEEL CRANKSHAFT - 12 BOLT | BN1-BN2 | FOR 12 BOLT FLYWHEEL | £2,065.00 |
| 61 | COM242 | STEEL CRANKSHAFT - 8 BOLT | BN4-BJ8 | FOR 8 BOLT FLYWHEEL | £2,195.00 |
| 61 | COM243 | STEEL CRANKSHAFT - 12 BOLT | BN4-BJ8 | FOR 12 BOLT FLYWHEEL | £2,195.00 |
| 61B | COM243B | 12-Bolt Steel flywheel bolt kit | BN1-BJ8 | FOR 12 BOLT FLYWHEEL | £27.85 |
| 62 | COM244 | ALUMINIUM BACK PLATE - STD CRANK | BN4-BJ8 | MUST FIT WITH COM162 | £128.50 |
| 62 | COM244C | ALUMINIUM BACK PLATE-12 BOLT CRANK | BN1-BN2 | MUST FIT WITH COM248 | £210.00 |
| 62 | COM244E | ALUMINIUM BACK PLATE-12 BOLT CRANK | BN1-BN2 | 6 CYL. HYD CLUTCH B/HOUSING | £210.00 |
| 62 | COM245 | ALUMINIUM BACK PLATE-12 BOLT CRANK | BN4-BJ8 | MUST FIT WITH COM248 | £138.50 |
| 63 | COM246 | BIG END BEARING SET - std | BN1-BN2 | FOR STEEL CRANK ONLY | £29.50 |
| 63 | COM246R | RACE BIG END BEARING SET - std | BN1-BN2 | FOR STEEL CRANK ONLY | £97.50 |
| 63 | COM247 | BIG END BEARING SET - std | BN4-BJ8 | FOR STEEL CRANK ONLY | £43.50 |
| 63 | COM247R | RACE BIG END BEARING SET - std | BN4-BJ8 | FOR STEEL CRANK ONLY | £142.50 |
| 64 | COM248 | OIL SEAL | BN1-BJ8 | FOR STEEL 12 BOLT CRANK | £15.75 |



Whether you are a serious competitor or just looking for a little more from your Big Healey, our new Performance catalogue is packed full of quality parts to enhance the enjoyment and performance of your Austin Healey. Please contact us today for your free copy.

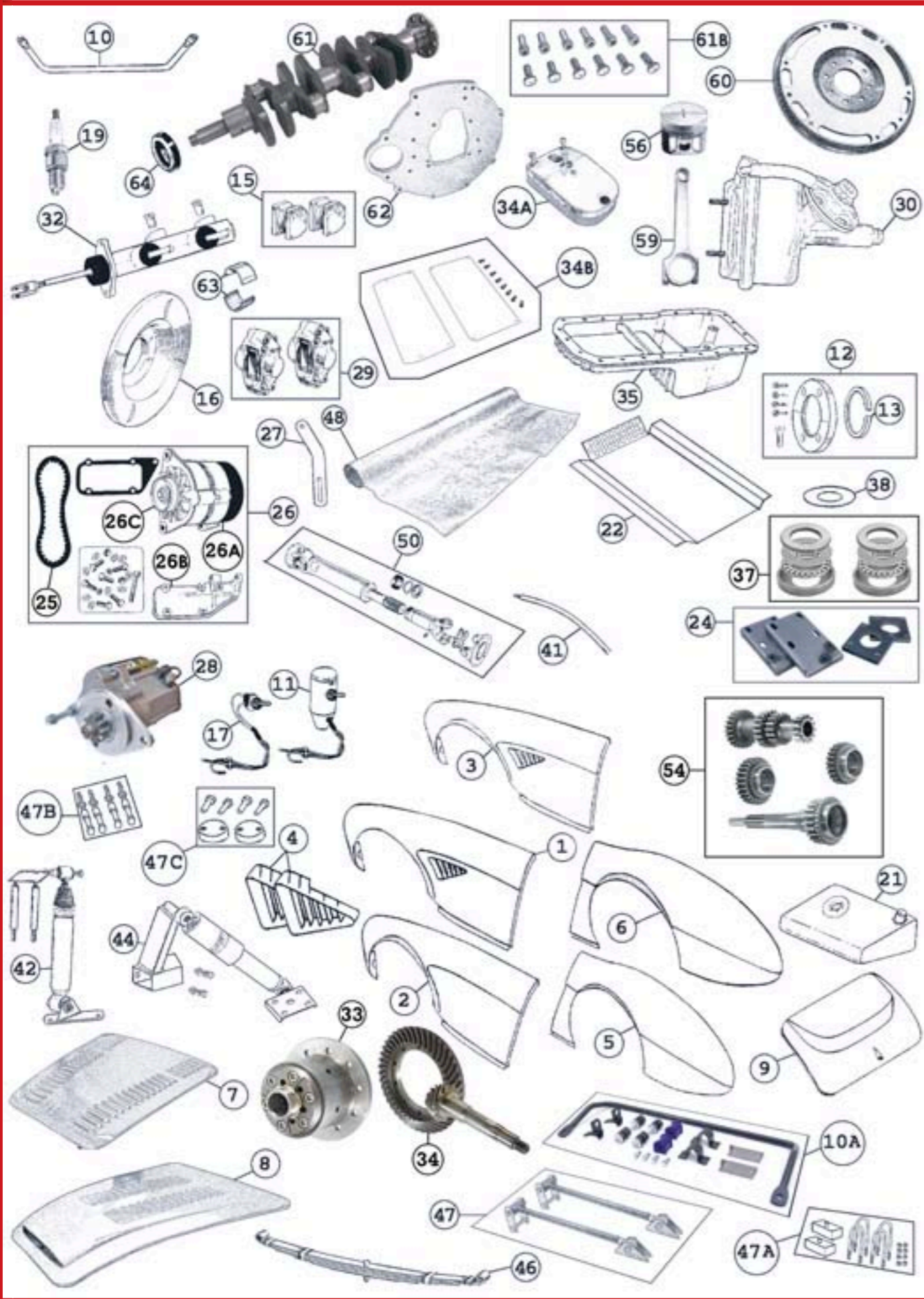

| No. | Part No. | Description | Application | Notes | Price ex VAT |
|-----|----------|-------------------------------------|----------------|------------------------|--------------|
| 65 | COM250 | SUPER CLAMP - 40-43mm | A/R | S.STEEL | £2.10 |
| 65 | COM251 | SUPER CLAMP - 43-47mm | A/R | S.STEEL | £2.10 |
| 65 | COM252 | SUPER CLAMP - 47-51mm | A/R | S.STEEL | £2.10 |
| 65 | COM253 | SUPER CLAMP - 51-55mm | A/R | S.STEEL | £2.49 |
| 65 | COM254 | SUPER CLAMP - 55-59mm | A/R | S.STEEL | £2.53 |
| 65 | COM255 | SUPER CLAMP - 59-63mm | A/R | S.STEEL | £2.25 |
| 65 | COM256 | SUPER CLAMP - 63-68mm | A/R | S.STEEL | £2.25 |
| 68 | COM259 | HALF SHAFT - uprated | BN1-BN1.221535 | | £249.50 |
| 68 | COM260 | HALF SHAFT - uprated | BN1.221536-BJ8 | | £209.50 |
| 68A | COM261 | COMPETITION HUB SEALS | BN1.221536-BJ8 | | £12.95 |
| 69 | COM262 | CLUTCH KIT - HEAVY DUTY | BN4-BJ8 | USE.CLU113HD | - |
| 71 | COM264 | ROLLER ROCKER KIT | BN1-BN2 | | £550.00 |
| 71 | COM266 | ROLLER ROCKER KIT | BN4-BJ8 | | £799.00 |
| 71A | COM270 | ROCKER SHAFT-UPRATED COMP | BN4-BJ8 | USE.ENG700R | - |
| 71B | COM271 | COMPETITION ROCKER PEDESTAL | BN4-BJ8 | ALUMINIUM - PLAIN | £25.95 |
| 71B | COM271D | COMPETITION ROCKER PEDESTAL | BN4-BJ8 | ALUMINIUM - DRILLED | £36.95 |
| 71C | COM271S | ROCKER SPACER SET | BN4-BJ8 | ALUMINIUM | £37.75 |
| 72 | COM272 | VALVE-inlet COMPETITION | BN4-BJ8 | USE.ENG720C | - |
| 72 | COM273 | VALVE-exhaust COMPETITION | BN4-BJ8 | USE.ENG721C | - |
| 73 | COM274 | VALVE SPRING SET - heavy duty | BN4-BJ8 | | £33.50 |
| 73A | COM274C | VALVE SPRING CUP | BN4-BJ8 | DOUBLE SPRINGS 7500RPM | £8.25 |
| 74 | COM275 | TUBULAR PUSH RODS- (car set) | BN4-BJ8 | MUST USE WITH COM276 | £182.50 |
| 74A | COM276 | BUCKET CAM FOLLOWER | BN4-BJ8 | MUST USE WITH COM275 | £6.95 |
| 74A | COM276C | BUCKET CAM FOLLOWER COMP | BN4-BJ8 | MUST USE WITH COM275 | £9.75 |
| 74A | COM276E | BUCKET CAM FOLLOWER-SET | BN1-BN2 | USE.ENG461 | - |
| 74B | COM277 | TAPPET COVER ALUMINIUM | BN4-BJ8 | PLAIN | £45.95 |
| 74C | COM278 | TAPPET COVER ALUMINIUM-W/Breather | BN4-BJ8 | WITH BREATHER | £49.50 |
| 75 | COM280 | ALLOY CYLINDER HEAD-FAST ROAD | BN4-BJ8 | C/W VALVES | £3,050.00 |
| 75 | COM281 | ALLOY CYLINDER HEAD-FULL RACE | BN4-BJ8 | C/W VALVES | £3,395.00 |
| 79 | COM288 | NEEDLE ROLLER CAM BEARING | BN4-BJ8 | USE WITH ENG654 | £14.75 |
| 79A | COM289 | CAM GEAR STEEL-VERNIER | BN4-BJ8 | USE.ENG649V | - |
| 79B | COM289A | HYDRAULIC TENSIONER-timing chain | BN4-BJ8 | USE.ENG650H | - |
| 80 | COM290 | COMPETITION SEAT BELT - BLACK | BN1-BJ8 | FIA APPROVED | £109.50 |
| 80 | COM291 | COMPETITION SEAT BELT - BLUE | BN1-BJ8 | FIA APPROVED | £109.50 |
| 80 | COM292 | COMPETITION SEAT BELT - RED | BN1-BJ8 | FIA APPROVED | £109.50 |
| 83 | COM296 | RALLY STYLE DASHBOARD-RHD | BJ8 | BLACK CRACKLE FINISH | £415.00 |
| 83 | COM297 | RALLY STYLE DASHBOARD-LHD | BJ8 | BLACK CRACKLE FINISH | £415.00 |
| 85 | COM300 | INNER SILL PANEL-R/H-UPRATED | BN1-BJ8 | 1.5MM | £16.45 |
| 85 | COM301 | INNER SILL PANEL-L/H-UPRATED | BN1-BJ8 | 1.5MM | £16.45 |
| 86 | COM302 | INTERMEDIATE SILL-R/H-UPRATED | BN1-BJ8 | 1.5MM | £16.45 |
| 86 | COM303 | INTERMEDIATE SILL-L/H-UPRATED | BN1-BJ8 | 1.5MM | £16.45 |
| 86A | COM304 | RUB/COT BRAID 5/16" PETROL HOSE-MTR | BN1-BJ8 | PER MTR | £4.15 |
| 86B | COM304A | 90 DEGREE UNION | BN1-BJ8 | FOR FACET PUMP | £3.15 |
| 86C | COM304B | FACET PUMP MOUNTING KIT | BN1-BJ8 | FOR FACET PUMP | £5.65 |
| 87 | COM305 | COMPETITION FACET FUEL PUMP | BN1-BJ8 | NEGATIVE EARTH | £67.50 |
| 87A | COM308 | PLASTIC FUEL TANK - 100 litre | A/R | ATL-FOAM FILLED | £725.00 |
| 87C | COM309 | FUEL TANK ALUMINIUM - 45 LITRE | A/R | FIA FOAM FILLED | £520.00 |
| 87C | COM309L | FUEL TANK ALUMINIUM - 105 LITRE | A/R | FIA FOAM FILLED | £895.00 |

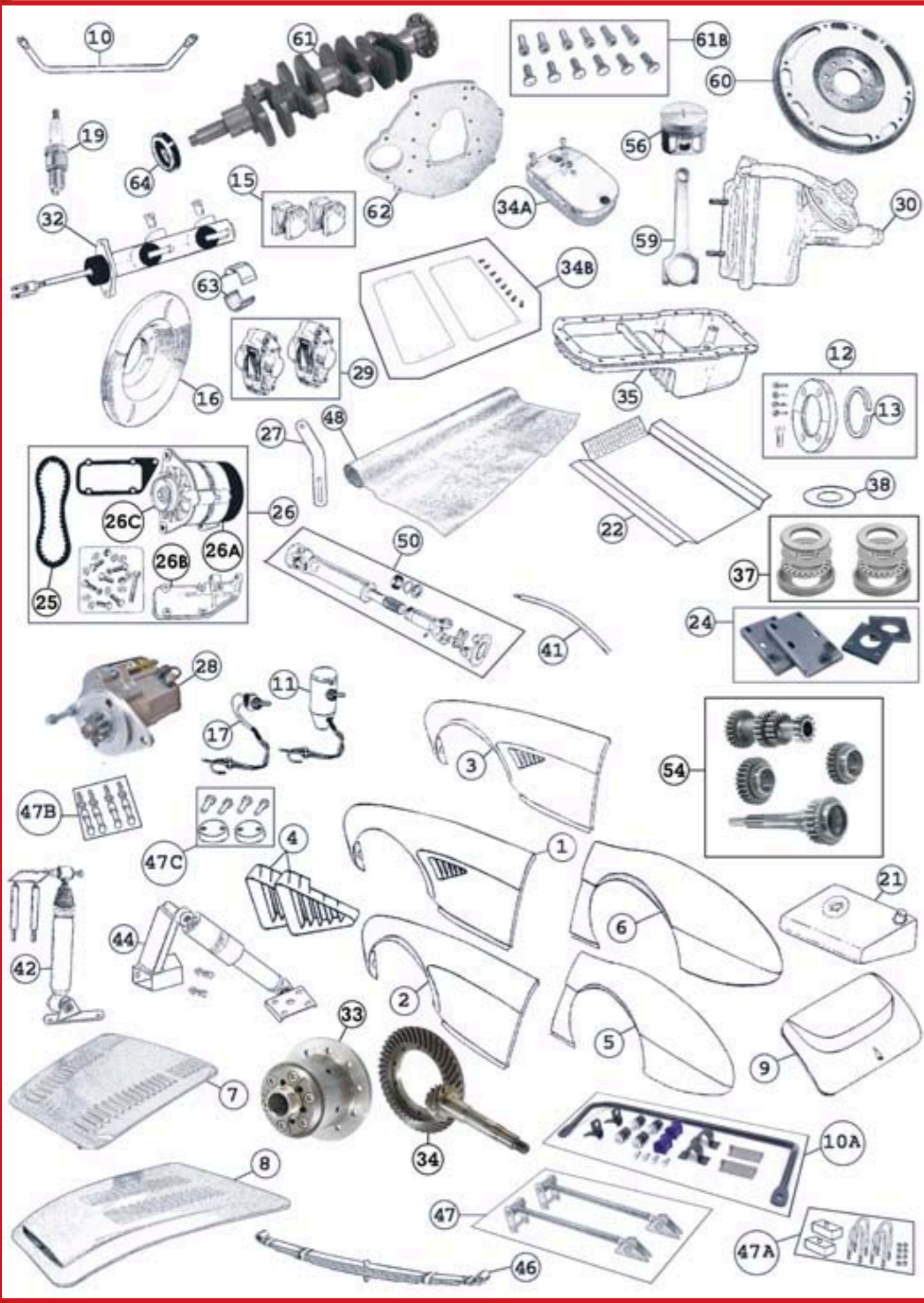

| No. | Part No. | Description | Application | Notes | Price ex VAT |
|------|----------|--|---------------|------------------------------------|--------------|
| 88 | COM310 | COMPETITION BATTERY CUT-OFF SWITCH | A/R | FIA APPROVED | £20.95 |
| 89 | COM312 | 'T' PULL CABLE 6' | A/R | | £8.75 |
| 89 | COM313 | 'T' PULL CABLE 12' | A/R | | £14.50 |
| 90 | COM314 | FRONT SPRING-COMPETITION-500lb | BN1-BJ8 | RACE/RALLY | £37.75 |
| 90 | COM315 | FRONT SPRING-COMPETITION-600lb | BN1-BJ8 | RACE/RALLY | £37.75 |
| 90 | COM317 | FRONT SPRING-COMPETITION-800lb | BN4-BJ8 | RACE ONLY | £37.75 |
| 90 | COM318 | FRONT SPRING-COMPETITION-900lb | BN4-BJ8 | RACE ONLY | £40.50 |
| 95 | COM322 | SHOCK ABSORBER-R/H-ADJUSTABLE | BJ8 | EARLY CARS USE IBP286 | £455.00 |
| 95 | COM323 | SHOCK ABSORBER-L/H-ADJUSTABLE | BJ8 | EARLY CARS USE IBP286A | £455.00 |
| 97 | COM326 | CRANK SUPER DAMPER | BN1-BJ8 | | £299.95 |
| 97 | COM326R | O-RING KIT - SUPER DAMPER | BN1-BJ8 | 3 GROOVE | £81.75 |
| 98 | COM327 | PULLEY | BN1-BJ8 | USE WITH COM326 | £98.50 |
| 99 | COM328 | MODIFIED FRONT YOKE-super damper | BN4-BJ8 | USE WITH COM326 | £74.50 |
| 102 | COM340 | WEBER CONVERSION KIT | BN4.68960-BJ8 | INC MANIFOLDS/ LINKAGES/RAIL | £1,980.00 |
| 102 | COM341 | WEBER CARBURETTOR | BN4-BJ8 | 45 DCOE | £297.50 |
| 102A | COM342 | WEBER INLET MANIFOLD SET | BN4-BJ8 | SET OF 3 MANIFOLDS | £379.50 |
| 102B | COM343 | WEBER GASKET-METAL/RUBBER | BN1-BJ8 | GENUINE MISAB GASKETS (2 PER CARB) | £2.45 |
| 103 | COM344 | THROTTLE LINKAGE KIT-RHD | BN4-BJ8 | USE WITH WEBERS | £525.00 |
| 103 | COM344L | THROTTLE LINKAGE KIT-LHD | BN4-BJ8 | USE WITH WEBERS | £525.00 |
| 104 | COM346 | WEBER FUEL RAIL | A/R | | £178.95 |
| 104A | COM346A | ADAPTOR - Weber fuel rail | A/R | TO FUEL FLEXI PIPE | £7.50 |
| 105 | COM347 | WEBER HEATSHEILD KIT | BN1-BJ8 | | £19.95 |
| 106 | COM348 | WEBER AIR FILTER SOCKS-DUAL | BN4-BJ8 | PIPERCROSS 45DCOE | £21.95 |
| 107 | COM349 | RAMPIPE-full radius 30mm height | BN4-BJ8 | WEBER 45DCOE | £21.00 |
| 112 | COM354 | KNOCK BACK CALIPER SPRINGS | A/R | FRONT AND REAR CALIPERS | £4.95 |
| 113 | COM355 | BRAKE DISCS-REAR | BN2-BJ8 | NOT SUITABLE FOR BN1 | £129.95 |
| 114 | COM356 | REAR CALIPER MOUNTINGS-PR | BN2-BJ8 | NOT SUITABLE FOR BN1 | £115.00 |
| 116 | COM358 | COMPETITION REAR BRAKE PADS | BN2-BJ8 | NOT SUITABLE FOR BN1 | £63.50 |
| 116 | COM358S | STANDARD REAR BRAKE PADS | BN2-BJ8 | ROAD/FAST ROAD | £28.95 |
| 118 | COM359 | REAR BRAKE CALIPER-RH | BN2-BJ8 | WITH HAND BRAKE CALIPER | £240.00 |
| 118 | COM360 | REAR BRAKE CALIPER-LH | BN2-BJ8 | WITH HAND BRAKE CALIPER | £240.00 |
| 118 | COM361 | REAR CALIPER REPAIR KIT | BN2-BJ8 | LARGE BELLOWS TYPE | £18.95 |
| 118 | COM361A | REAR CALIPER REPAIR KIT | BN2-BJ8 | SMALL WITH CIRCLIP | £18.95 |
| 118 | COM362 | PAD RETAINING KIT - rear brake caliper | BN2-BJ8 | | £7.95 |
| 118 | COM363 | HANDBRAKE PAD SET - rear brake caliper | BN2-BJ8 | | £17.50 |
| 121 | COM364 | BRAIDED CALIPER LINK PIPE SET - rear | BN2-BJ8 | PAIR | £39.00 |
| 125 | COM365 | REAR WHEEL ADAPTOR 127MM-PR | BN2-BJ8 | USE.WHE117A | - |
| 130 | COM370 | CATCH TANK (OIL) | BN1-BJ8 | FITS BEHIND WHEEL ARCH | £115.00 |
| 135 | COM375 | FUEL PRESSURE REGULATOR-FILTER KING | BN1-BJ8 | INC BRKT+PRESSURE GAUGE | £69.00 |
| 150 | COM385 | BRAKE BALANCE BAR | A/R | | £57.50 |
| 152 | COM387 | BRAKE BIAS ADJUSTER CABLE | A/R | | £63.75 |



For all our competition parts, please contact us for a copy of our A.H. Performance catalogue.

www.ahperformanceparts.co.uk